

INSTALLATION MANUAL

11128G

LED
BUILT IN



90
CRI

CE ENEC UK CA



134mm



58mm

110mm

230V | COB LED | 28W | IP20 | Adjustable beam | Aluminium

Complete with 750mA driver.



one
LIGHT

A

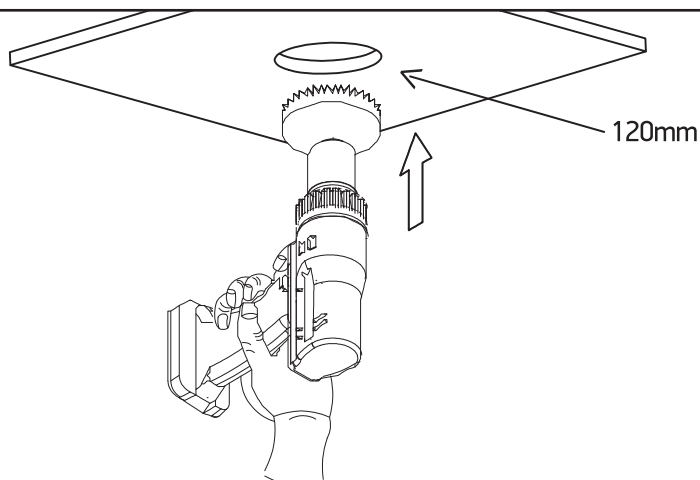

B

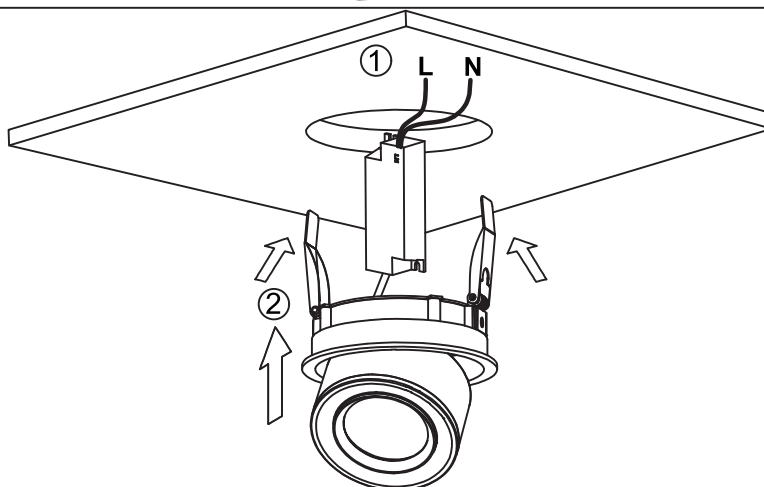

C

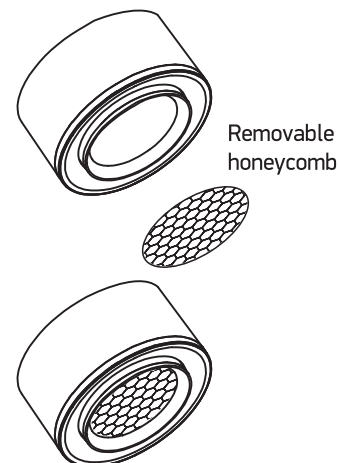
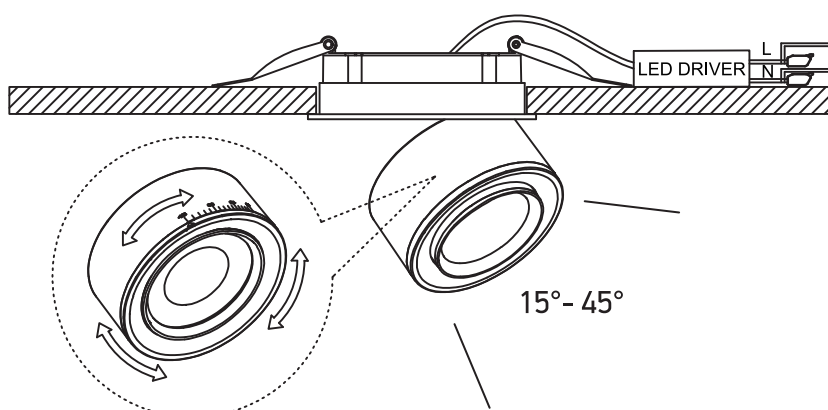

Warnings:

1. Make sure that the product is installed properly before connecting to electricity.
2. Do not cover the fitting.
3. Maintenance and installation should only be carried out by a professional electrician.